



# YESCO®

## SmartStrip™ Series

SmartStrip™

SS3-12

SS15-12

SS3-24

### LED Lighting Systems Installation Manual

(Version 1.3)

YESCO LLC, 5119 South Cameron Street, Las Vegas, NV 89118  
Tel: 702-876-8080 • Fax: 702 944-4500 • E-mail: [Eservice@yesco.com](mailto:Eservice@yesco.com) • [WWW.YESCO.COM](http://WWW.YESCO.COM)

Copyright © 2008-2013 YESCO LLC, All rights Reserved • Specifications are subject to change without notice



## SmartStrip™ Installation (Version 1.3)

---

### Table of Contents

|                               |   |
|-------------------------------|---|
| Introduction .....            | 1 |
| Mounting Diagrams.....        | 2 |
| Mounting Guide.....           | 3 |
| System Layout .....           | 4 |
| Electrical Connections .....  | 5 |
| Electrical Terminations ..... | 6 |

## SmartStrip™ Installation (Version 1.3)

The YESCO LED Smart Puck products are available in a wide variety of configurations made specifically for custom applications. These instructions are intended to be used as a reference to understanding how the system functions and provide a walk-through the typical installation process. All installations are unique, with different characteristics which these instructions may not cover. Begin with the provided information and feel free to contact Yesco for any specific questions about your project.

- Please read through these instructions and familiarize yourself with all components of the lighting system prior to installation.
- Look for any additional documentation that has come packaged with individual components or other manufactures and follow any recommended guidelines and procedures during installation.
- Carefully unpack and inspect the parts included with your lighting system ensuring all parts on the packing list have arrived undamaged, if parts are missing or damaged please contact Yesco prior to installation.

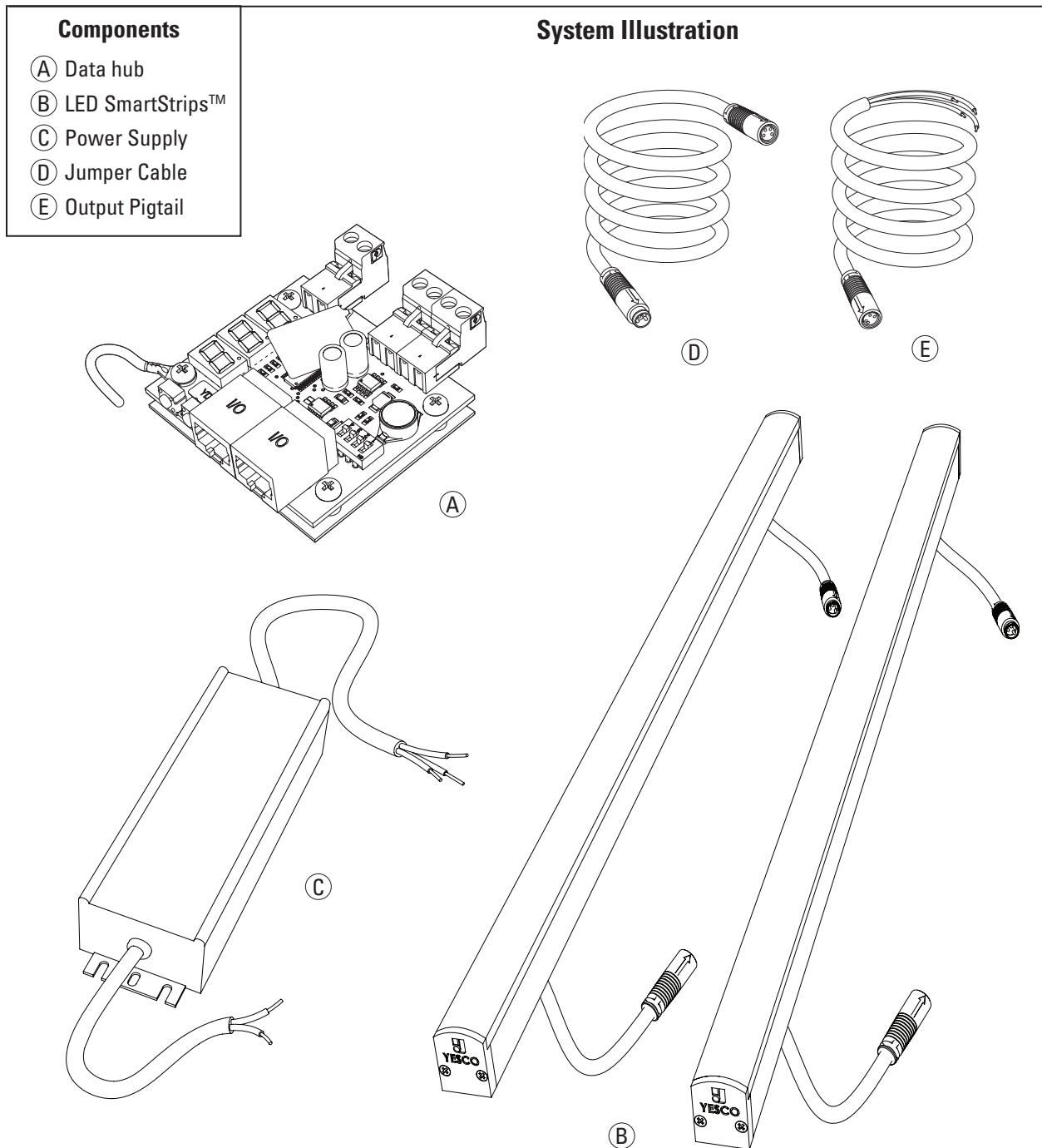

## SmartStrip™ Installation (Version 1.3)

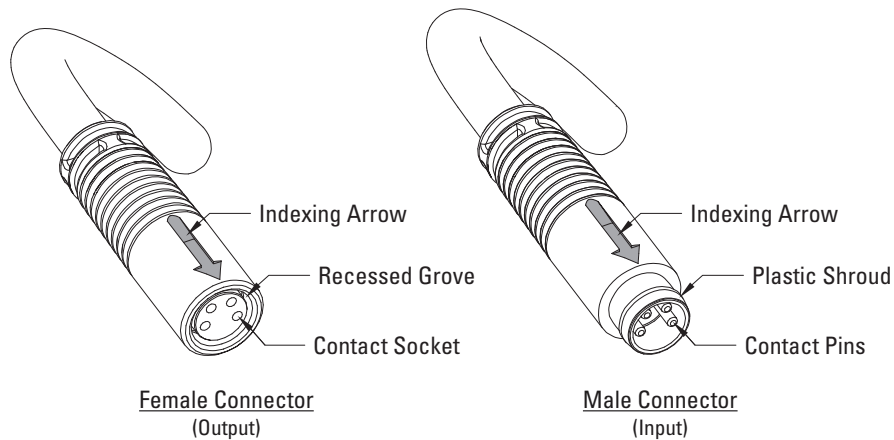

1. Locate and align the indexing arrows on a male and female connector
2. Press the connectors together maintain alignment of indexing arrows
3. Feel for a tactile engagement and slight click sound to confirm a fully seated connection

\* When assembling or disconnecting connectors, do not bend or pry, only press or pull in the same direction of the arrows as shown.

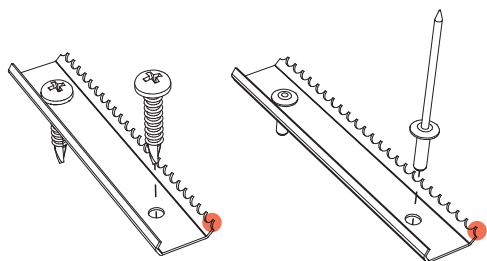
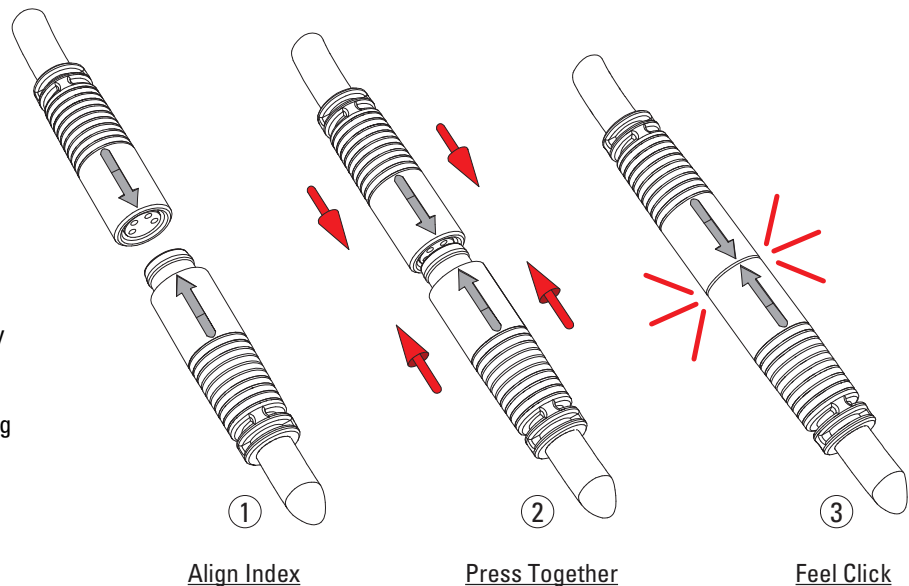

### Screw Installation

● Denotes Serrated Edge

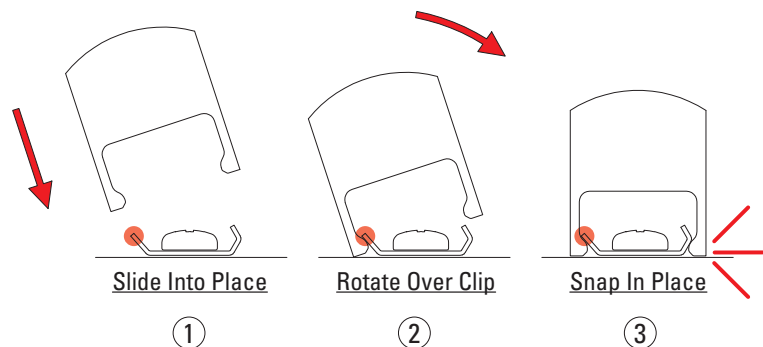

Stainless steel mounting clips are provided to secure the LED strips, these can be fastened to the mounting surface using #6 screws, 1/8" blind rivets, or other mechanical fastener suited for the surface material.

1. Place the LED strip assembly over the mounting clips aligning the serrated edges along one inside edge
2. Rotating the assembly until the other inside edge resting over the mounting clips
3. Press down and rotate the open edge until it snaps into place, check to see if all clips are fully seated

## SmartStrip™ Installation (Version 1.3)

Layout the area where the LED strips will be mounted ensuring the surface is flat and free of any debris which may interfere with the installation process. Please check the mounting surface to ensure it's strong enough to support the weight of the LED Strips and attachment of the mounting clips.

When selecting a place for the clips, be aware of anything that may be hidden under the area where fasteners are installed to avoid any damage. If there are obstructions behind, please look for a location nearby which is more suitable for installing mounting clips with mechanical fasteners.

Locate the mounting clips using Figure 1-1 as a guide in relationship to each LED Fixture. Do not place the mounting clip directly behind any connectors as shown in Figure 1-6, this will not allow the clip to fully seat into the LED Strip. On strips longer than 20" mounting clips should be at least 5.5" from each end cap to clear any connectors. When securing shorter led strips, locate a single mounting clip in the center of the fixture to attach it to the installation surface. Be aware of which direction each mounting clip is orientated, facing all serrated edges along the same side while ensuring parallel alignment of all clips allowing the aluminum housing to be installed and secured easily.

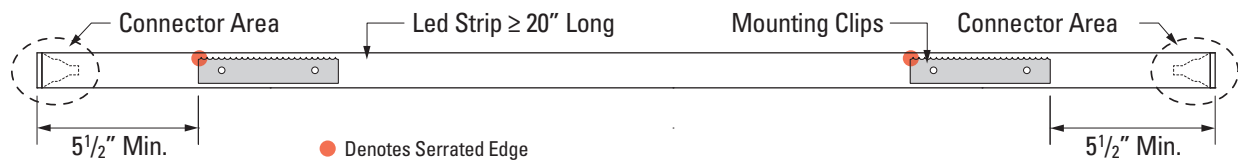

**Figure 1-1**

If the selected mounting surface is a continuous flat plane, these led strips feature a self enclosed raceway to house any required wiring. Looking on the back side of each strip you will find a recessed channel with rubber end caps integrated with the wiring. When choosing to use this raceway option, the end caps have two wire passages which requires removal allowing wires to pass through each strip.

1. Locate the thin wall section of each rubber end cap from underneath shown in Figure 1-2, this outlines where each wire passage opening is located.
2. Using diagonal cutters or sharp knife carefully cut along each cut line of the selected wire passage shown in Figure 1-3, removing any material that remains, ensure that the cable and adjacent end cap area is not damaged during this process.
3. Check to be sure that the correct wire passage is opened up on the adjacent led strip so wiring can pass through each end freely shown in Figure 1-4 and Figure 1-5.

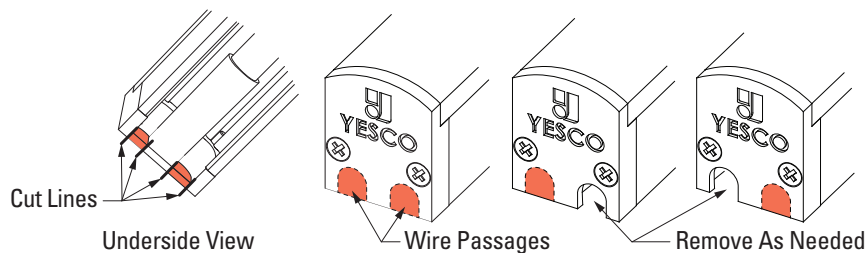
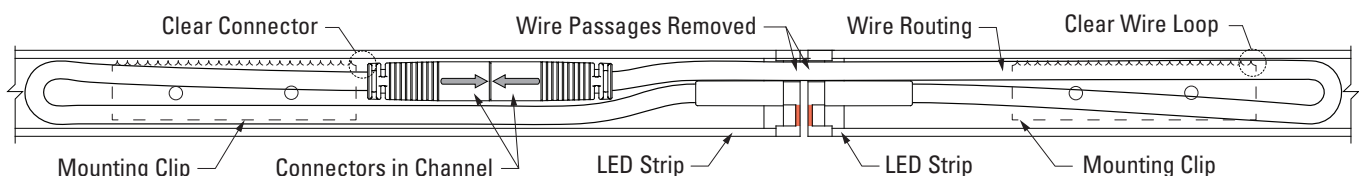

**Figure 1-2**

**Figure 1-3**

**Figure 1-4**

**Figure 1-5**



**Figure 1-6**

## SmartStrip™ Installation (Version 1.3)

Figure 1-7

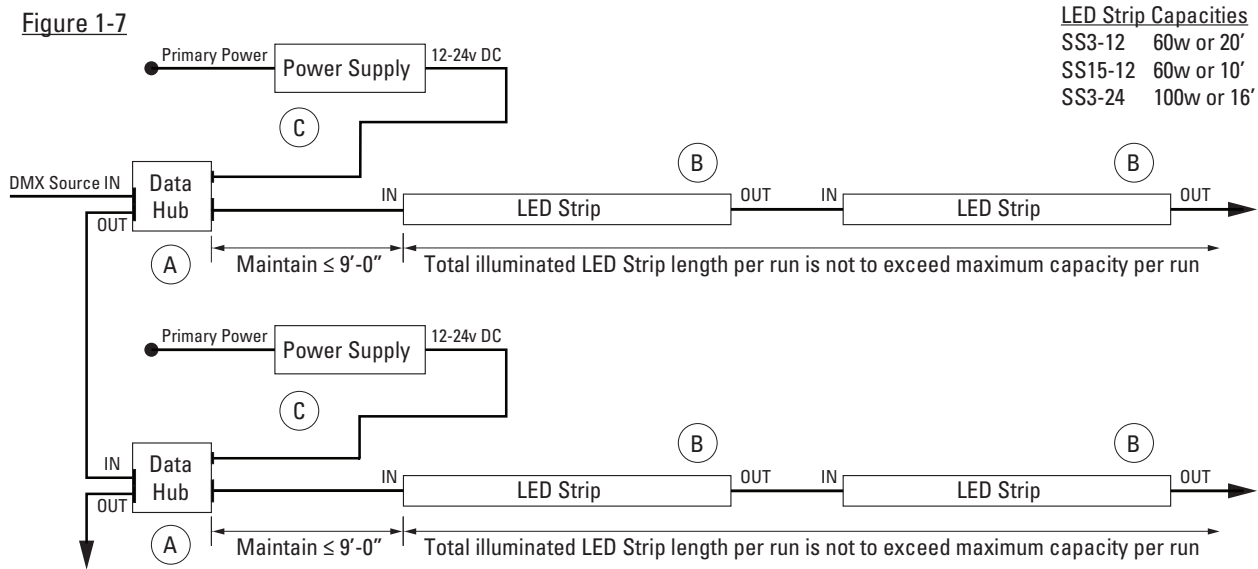

Figure 1-7 shows a general connection diagram of the various components making up the LED Strip system, when planning the installation be aware of the other parts and relationships that need to be maintained. The LED Strips are weather resistant and designed for exterior usage. For the other supporting components a sheltered location nearby with easy access should be accounted for in the planning stages.

During installation, remember there two ends of each strip which are not interchangeable, being aware of proper direction the strips when installing will help prevent errors and reduce the need for troubleshooting during the electrical connection process.

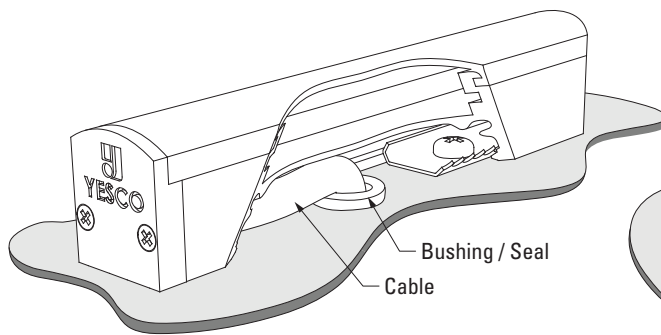

Figure 1-8

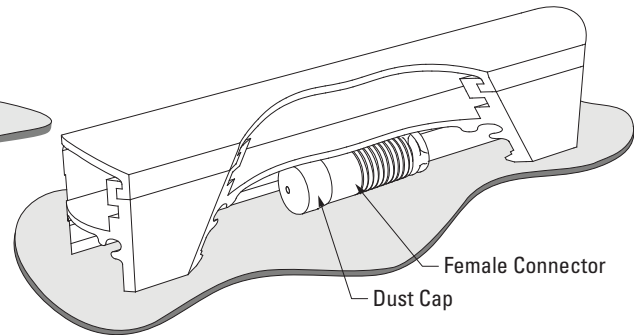

Figure 1-9

For a concealed cable installation, it may be necessary to penetrate the mounting surface shown in Figure 1-8, to route cables; please use an appropriate device to protect the cable from any chafing damage while providing the required weather seal.

On all installations it is important to maintain a total cable length of 9'-0" or less from data hub to first LED Strip, trimming down the included output pigtail to length is fine, but do not make any cable extensions. Refer to Figure 1-10 for the correct terminals when wiring the output pigtail into the data hub. Always power down the data hub prior to connecting or disconnecting anything from the output side.

When reaching the last strip of each run, the female end connector must be capped off with a dust cap as shown in Figure 1-9 and the remaining cable tucked under the LED strip prior to final mounting of the strip.

## SmartStrip™ Installation (Version 1.3)

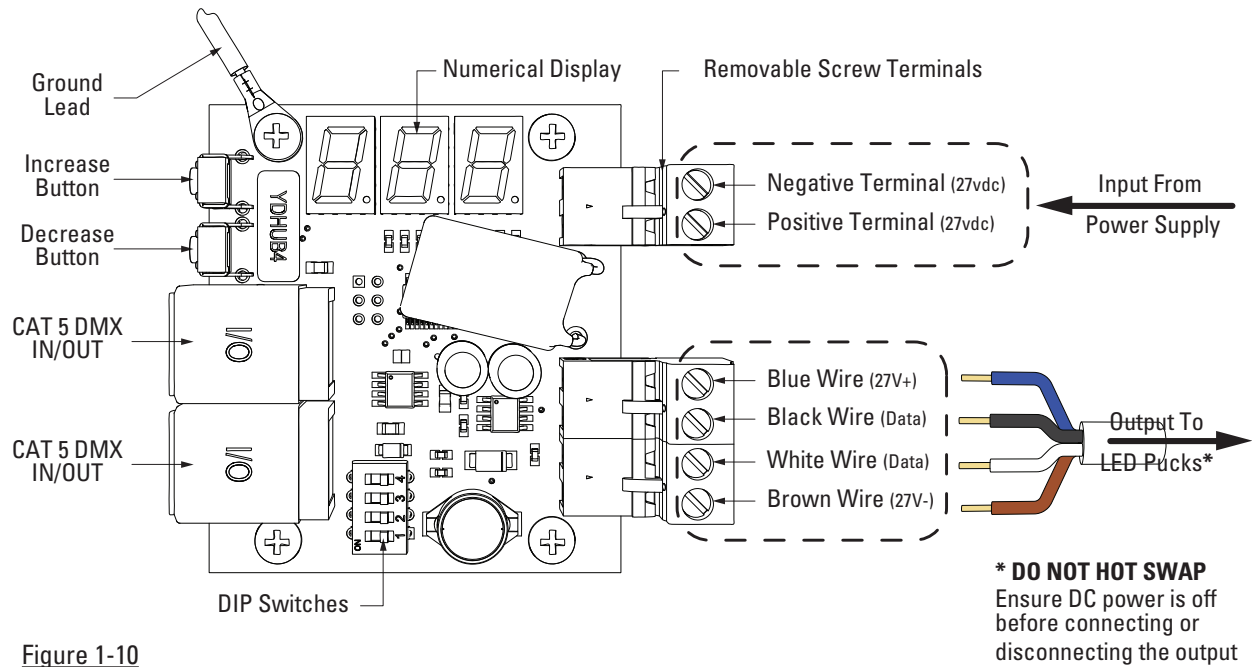

Figure 1-10

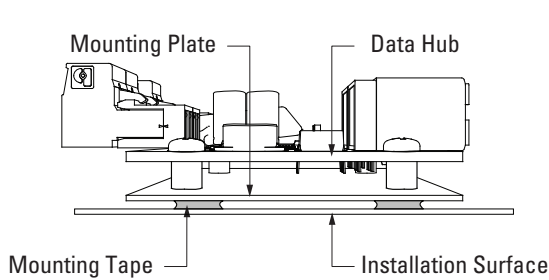

Figure 1-11

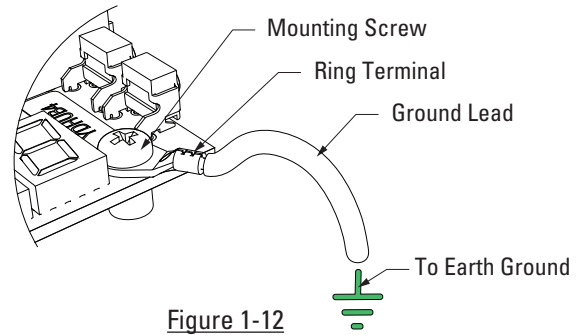

Figure 1-12

When mounting the data hub into an enclosure, clearance for accessing the buttons and installation or removal of all connectors should be considered. Mounting on a solid substrate with mounting tape is recommended shown in Figure 1-11 and silicone can also be used for additional security. **It is important to find a good earth ground and make a connection with the grounding lead on the Data Hub** as shown in Figure 1-12.

Install the power supply into the enclosure according to the manufactures instructions while complying with the governing codes. It is recommended that only qualified personnel knowledgeable in electrical installations and regulations are making the connections.

## SmartStrip™ Installation (Version 1.3)

---

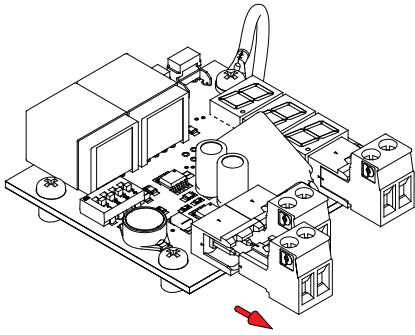

Figure 1-13

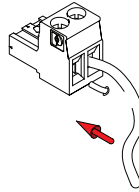

Figure 1-14

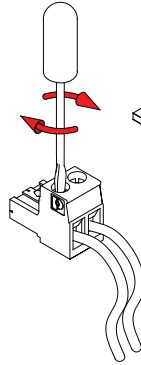

Figure 1-15

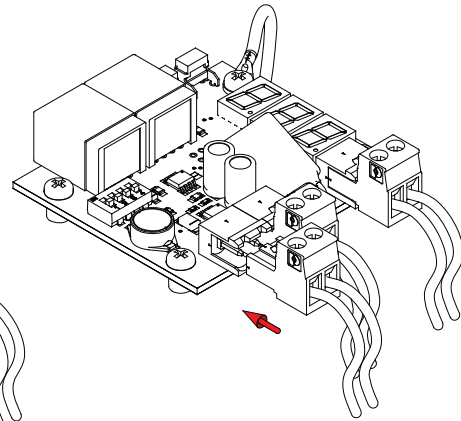

Figure 1-16

Removable screw terminal contacts are provided to ease installation of wires, to start please remove terminals from the data hub shown in Figure 1-13, then insert a stripped wire end into the proper location shown in Figure 1-14 and tighten with a flat bladed screwdriver to no more than 0.6 Nm of force, shown in Figure 1-15. Then reinstall the terminals in the proper location once all wires have been attached, shown in Figure 1-16.

Connect the power supply output to the data hub power input, refer back to power supply instructions if needed, the correct polarity and voltage is required for proper operation, refer to Figure 1-16 for more information.

Locate the input connector and pigtail from each run of LED Strips running them to the data hub location. If any holes are made please check to see that the cables are properly protected against abrasion while being sealed from exposure per location. Any wires that are run should be supported and secured along the entire length to minimize any damage. Connect the pre-stripped end of each cable lead to the data hub's output as shown on the guide in Figure 1-10. After everything is installed and connected go back through the entire system to check that all components are installed correctly and that there are no loose, missing or abnormal occurrences. Secure loose wiring as required to help reduce any damage to the system.

DO NOT power the system on after all electrical connections are made. The Data Hub outputs are not hot swappable, ensure that the power is shut off prior to connecting or disconnecting any LED fixtures. Please refer to the Data Hub operation manual in order to proceed with the next section of installation.